

Argosy Casino Hotel and Spa combines the excitement of Las Vegas with the genuine people and exceptional value of the Midwest. Offering state-of-the-art meeting space, a spectacular gaming floor and a luxury hotel and spa, we truly are the area's premier destination for business and for pleasure. Let our planners help arrange the perfect event for you.

#### MEETING FACILITIES

- More than 18,000 square feet of functional and elegant meeting space above the gaming floor
- Capable of accommodating up to 1,000 people, yet intimate enough for small gatherings
- Six meeting rooms, 3,000+ square feet of meeting space and 2,000+ square feet of pre-function space in the new hotel
- 8,000-square-foot Argosy Grand Ballroom, divisible into Cordoba, Marrakesh, Casablanca and Athens rooms
- Athens room features a balcony with stunning views of downtown Kansas City
- State-of-the-art AV capabilities, high-speed Internet and complete catering services

#### HOTEL & SPA

- 258 luxurious guest rooms
- Includes eight high-end suites featuring a living area, bedroom, powder room and bathroom with his/hers vanities, plus oversized soaking tub and shower
- 42-inch plasma screen TVs, refrigerators and plush, pillow-top bedding in every room
- Elegant bathrooms with mosaic tile, rain showerheads and granite countertops with dedicated TV speakers
- High-speed Internet access
- High-tech doorbell feature with lighted "do not disturb" and "service" lights
- Floor-to-ceiling glass windows in north-facing rooms on top six floors

- In-room laptop friendly safes
- State-of-the-art fitness center
- Gated, hotel key access-only parking lot
- Furnished VIP check-in
- Self-service business center
- Kiosk for printing airline boarding passes
- Massages, nail treatments, facials, tanning and retail products in the spa

#### CASINO

- 62,000-square-foot casino with domed stain-glass ceiling, Moroccan tile and in-laid terrazzo floors
- Extensive \$105 million renovation completed in 2003
- More than 1,800 coinless slot machines
- 48 table games
- Poker room with dedicated cashier's cage
- Two giant video screens and 50 plasma screen TVs throughout the gaming floor
- Modern ventilation system
- More than 850 computer-controlled tubular strobe lights for a Las Vegas-styled light show

#### DINING

- The Journey Wood-Fired Steaks, featuring Certified Angus Beef<sup>®</sup>, fish, lobster, pasta and more in a unique West African inspired setting
- Terrace Buffet, offering a cozy environment to enjoy freshly prepared breakfast, lunch and dinner seven days a week
- Crazy Olives, the perfect place to enjoy tasty dishes, great drinks and sporting events on big screen TVs
- Leo's Deli, a haven for sandwich lovers with handmade originals featuring Boar's Head Meats<sup>®</sup>
- Zoë's Coffee, Pastries and Gift Shop, offering freshly made coffee, snacks and cakes, hand-dipped ice cream and fun souvenirs

#### LOCAL ATTRACTIONS

- Close to the acclaimed Country Club Plaza, plus other shopping and entertainment districts
- Home to professional sports teams
- Minutes from newly revitalized downtown
- Easily accessible from Kansas City International Airport

#### DIRECTIONS

##### From Downtown Kansas City

Take the Broadway Extension North to Missouri 9. Exit onto Missouri 9 Westbound, until you reach the Interstate 635 interchange. Take I-635 South, as though headed for Kansas. Merge to the left-hand lane, as US 69 South branches from I-635 to the left. The Argosy Parkway Exit is immediately north of the Fairfax Bridge on the right-hand side of US 69.

##### From Kansas City International Airport

Take Interstate 29 South and exit onto Interstate 635 South, as though headed for Kansas. Merge to the left-hand lane, as US 69 South branches from I-635 to the left. The Argosy Parkway Exit is immediately north of the Fairfax Bridge on the right-hand side of US 69.

##### From Kansas

Take Interstate 635 North across the Missouri River. At the junction of I-635 and Missouri Highway 9, exit onto Missouri 9 (Riverside). The Argosy Parkway Exit is the first exit on the right, just east of the I-635/Missouri 9 junction. Take a right at the stop sign and a quick left onto Argosy Parkway.

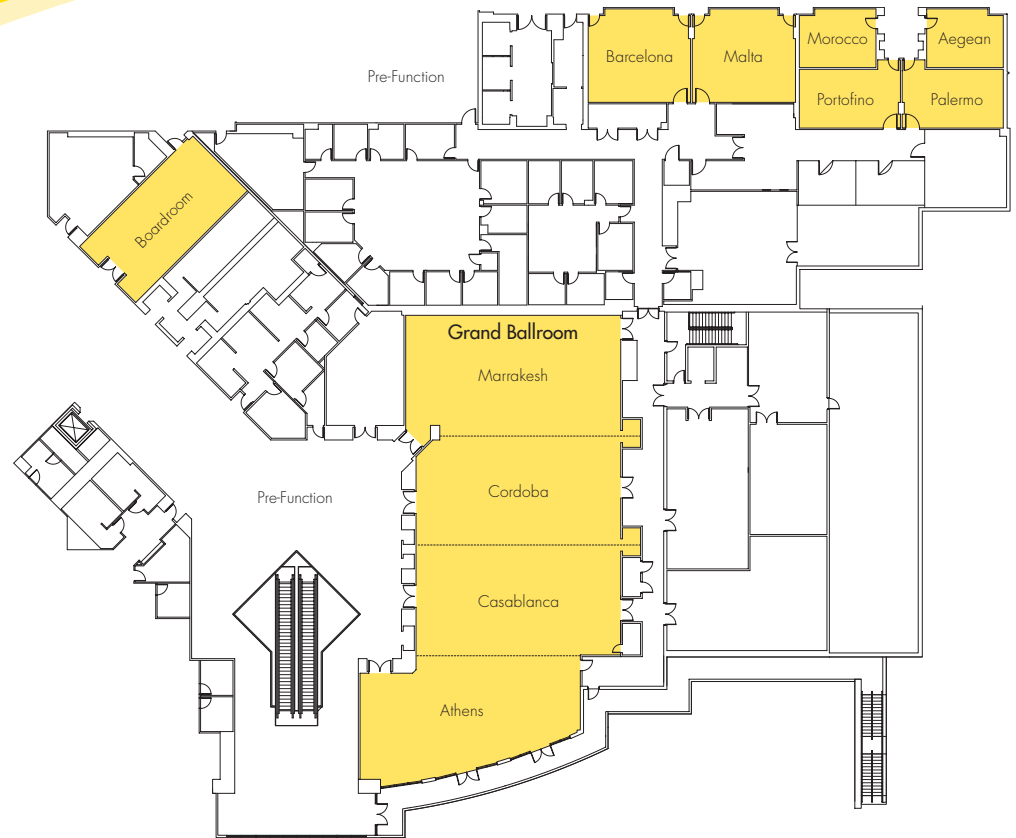

**Hotel Meeting Rooms**

Second Floor

Meeting Room	Square Feet	Dimensions	Height	Conference Style	Theater Style	Classroom	Banquet	U-Shape	Hollow Square	8 x 10 Booths
Pre-Function	2,152	-	10'	-	-	-	-	-	-	-
Barcelona	706	29' x 27'	8'8"	22	48	27	40	18	24	-
Malta	703	29' x 27'	8'8"	22	48	27	40	18	24	-
Morocco	337	22' x 17'	8'8"	14	18	12	10	12	16	-
Aegean	337	22' x 17'	8'8"	14	18	12	10	12	16	-
Portofino	485	29' x 17'	8'8"	22	24	18	20	19	23	-
Palermo	485	29' x 17'	8'8"	22	24	18	20	19	23	-

**Casino Meeting Rooms**

First Floor

Meeting Room	Square Feet	Dimensions	Height	Notes
Tuscany	931	24' x 32'	10'	Room has capacity of 60 at existing restaurant set-up.

Second Floor

Meeting Room	Square Feet	Dimensions	Height	Conference Style	Theater Style	Classroom	Banquet	U-Shape	Hollow Square	8 x 10 Booths
Pre-Function	4,882	-	10'	-	-	-	-	-	-	-
Grand Ballroom	7,844	120' x 59'	10'	-	550	375	400	-	-	38
Athens	2,192	24' x 37' x 63'	10'	28	100	50	80	26	28	8
Casablanca	1,793	31' x 58'	10'	40	130	70	80	34	40	10
Cordoba	1,793	31' x 58'	10'	40	130	70	80	34	40	10
Marrakesh	2,066	39' x 62'	10'	40	140	90	100	34	40	10
Boardroom	960	24' x 40' x 10'	10'	30	-	-	-	-	-	-